

Refilling Instruction

saintink.com

not just ink but saintink

for Canon cartridges

BC05 Color

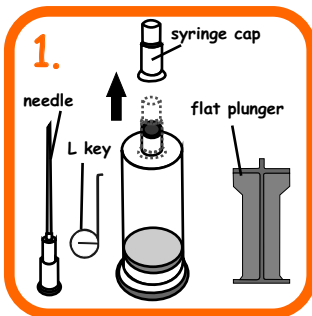

1. Setup the "Injection Tube" by removing the syringe cap then attach the needle & plunger to the ink tube.

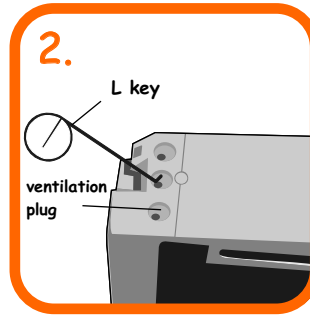

2. Remove the 3 ventilation plugs by fitting the L key into the small hole and gently pulling each out. Keep plugs for later use.

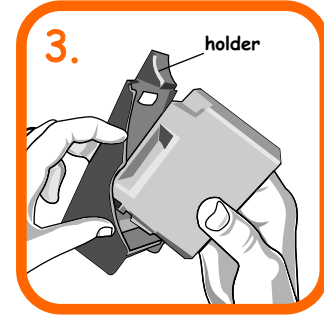

3. Install cartridge to holder.

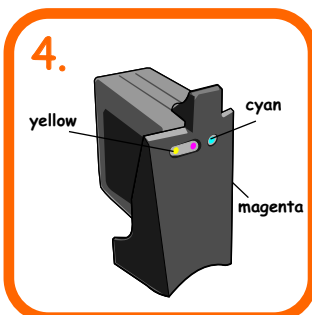

4. Study the position of each color.

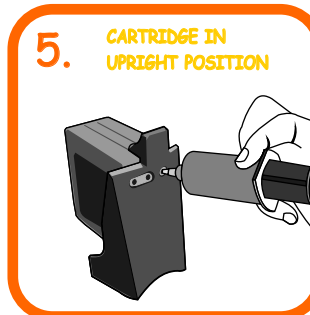

5. CARTRIDGE IN UPRIGHT POSITION. Push the needle into the cartridge and pull out a little (2mm). Slowly press the plunger to inject 4-5ml of ink into the cartridge. Ensure cartridge is in upright position. Stop filling if ink drips at print head.

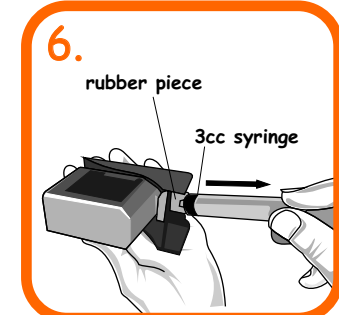

6. Insert the 3cc syringe to rubber piece at bottom of holder. Pull the plunger backwards to remove 0.5ml of ink from the cartridge.

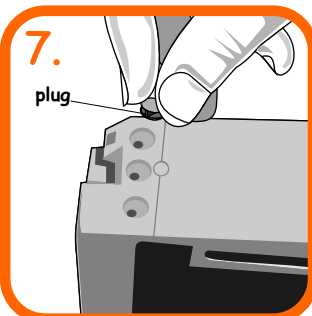

7. Remove cartridge from holder and seal holes with the plugs.

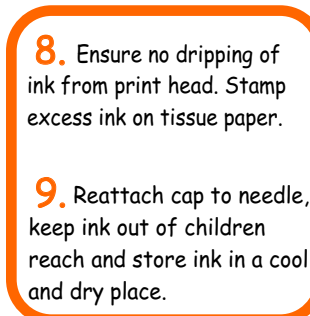

8. Ensure no dripping of ink from print head. Stamp excess ink on tissue paper.

9. Reattach cap to needle, keep ink out of children reach and store ink in a cool and dry place.

