

Refilling Instruction

saintink.com

not just ink but saintink

for **Canon** cartridges

BC11/21/24 Color

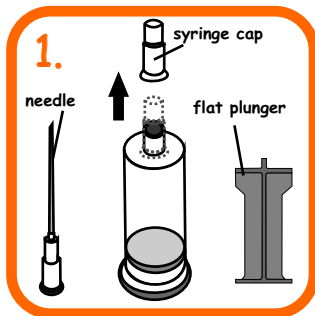

1. Setup the "Injection Tube" by removing the syringe cap then attach the needle & plunger to the ink tube.

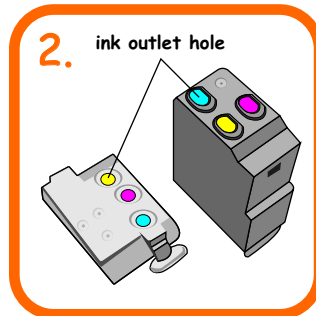

2. Place the cartridge with the ink outlet face up.

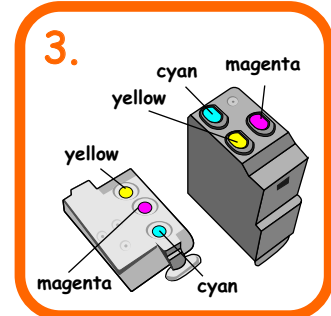

3. Study the position of the color and ensure the right color ink is injected into cartridge.

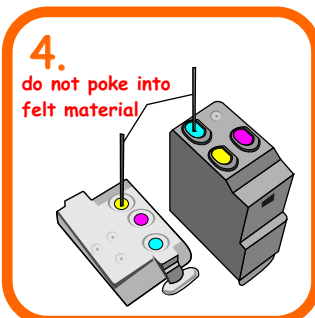

4. Gently drip ink onto the felt material (do not poke into material) and allow ink to absorb into the cartridge. Only fill the color which is empty.

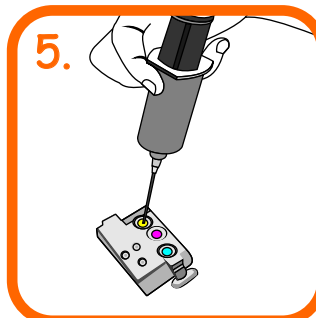

5. Only fill the following amount.
BC11 = 1ml
BC21/24 = 3ml



6. Place cartridge upright and observe for any dripping. Clear excess ink.

7. Install cartridge to printer and perform a nozzle check (run the head cleaning utility).

8. Reattach cap to needle, keep ink out of children reach and store ink in a cool and dry place.

