

# Refilling Instruction

saintink.com

not just ink but saintink

for HP cartridges

## HP51641, C1823, C6578, C6625 Color

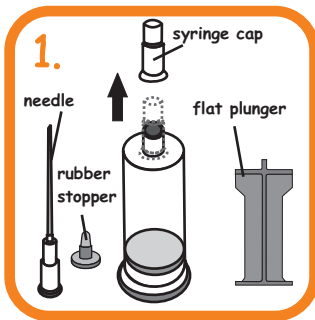

1. Setup the "Injection Tube" by removing the syringe cap then attach the needle & plunger to the ink tube.



2. Install cartridge to holder.



3. Push the ventilation plugs into the cartridge with plunger.

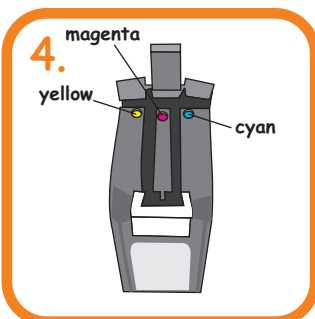

4. Study the position of the color and ensure the right color ink is injected into cartridge.

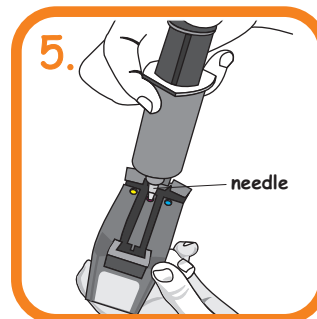

5. Push the needle into the cartridge and pull out a little (2mm). Slowly press the plunger to inject 5-8ml of ink into the cartridge. Ensure cartridge is in upright position. Stop filling if ink drips at print head.

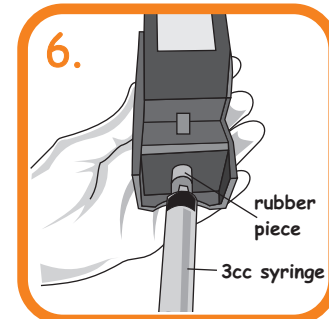

6. Insert the 3cc syringe to rubber piece at bottom of holder.

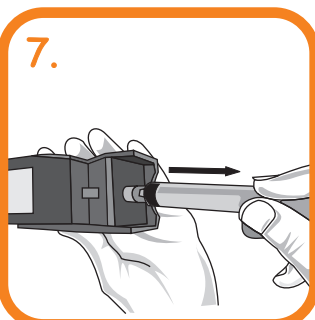

7. Pull the plunger backwards to remove 0.5ml of ink from the cartridge. Remove cartridge from holder.

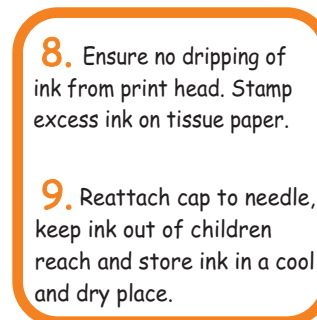

8. Ensure no dripping of ink from print head. Stamp excess ink on tissue paper.

9. Reattach cap to needle, keep ink out of children reach and store ink in a cool and dry place.

