

Refilling Instruction

saintink.com

not just ink but saintink

for HP cartridges

HP 21 / 27 / 56 / 60 / 74 / 92 /
94 / 96 / 98 / 702

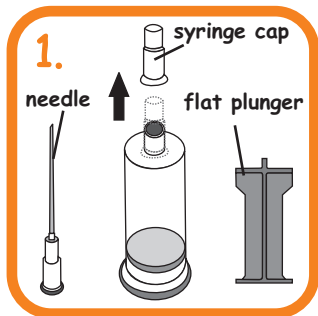

Setup the "Injection Tube" by removing the syringe cap then attach the needle & plunger to the ink tube.

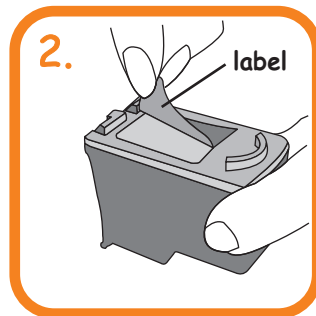

Remove the label on the cartridge.

3. CHECK YOUR CARTRIDGE MODEL & Follow Instruction for Color To Be Refill

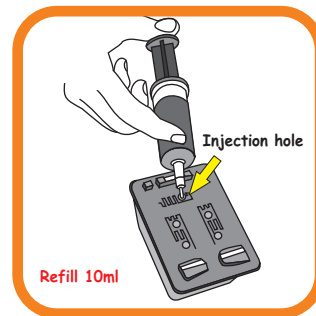

Refilling for HP 21/27/56/74/
94/96/98

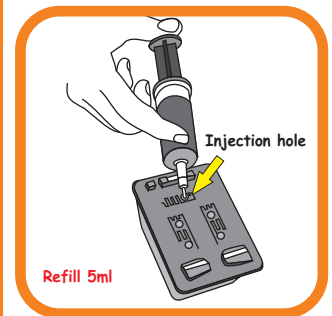

Refilling for HP 60/92/702

Push the needle straight into the cartridge and pull out a little (2mm). Slowly press the plunger to inject ink into the cartridge. Ensure cartridge is in upright position. Stop filling if ink start to drip at print head.



Dip the print head of the cartridge into water for 10 seconds.

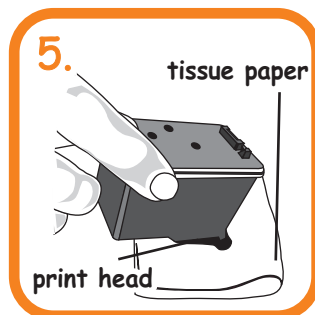

Clean print head by stamping gently on tissue paper.

6. Install cartridge to printer and perform a nozzle check (run the head cleaning utility).

7. Reattach cap to needle, keep ink out of children reach and store ink in a cool and dry place.

ATTN : The printer will not detect the ink level of a **refilled cartridge**. In this case, it is important that the monitoring of the ink level be done visually and top up the ink where necessary.

To continue printing without ink will damage the print head.

