



saintink.com

not just ink but saintink

User's Guide

HP 703/704

Maintenance Instruction

Avoid printing without ink by performing a "top up" approach. This is meant by refilling small amount of ink into the cartridge from time to time instead of waiting till the ink is exhausted from the cartridge.

Avoid exposing the cartridge to air for too long (more than 5 hours) as ink will dry up at print head and clog it.

Avoid over refilling and to ensure no dripping before installing the cartridge back into the printer.

TROUBLESHOOTING TIPS

<u>Problem</u>	<u>Possible Cause</u>	<u>Remedy</u>
1. Ink dripping from print head.	Overfilling.	Stamp print head on tissue until ink stop dripping.
2. Print quality not good.	Clogged or damaged print head.	Run head cleaning utility.
3. Print quality not good after running cleaning utility.	Clogged or air trapped at print head.	Soak print head (only print head portion) in hot water for few second and clean with tissue.
4. Print quality not good after running cleaning utility and soaking in hot water.	Damaged or air trapped at print head.	Leave cartridge in the printer for 12 hours and perform a nozzle check subsequently.
5. Print quality not good after running cleaning utility, soaking in hot water and left unused for 12 hours.	Damaged print head.	No possible repair. Change a new cartridge.
6. Color different or incorrect.	Filling wrong ink in the wrong column, overfilling or cartridge not in upright position when filling was done.	Run nozzle check to determine color mix. Clear mix color by printing following color until ink is exhausted from cartridge. Conduct a refill for color exhausted.
7. Cartridge not identified by printer.	Poor contact at copper connectors.	Wipe copper connectors (with alcohol solutions) or use an eraser to rub on copper connectors.

For support and more details to solving your technical issues, please visit www.saintink.com for more information.

Information provided here are subject to change without notice. Saintink is not responsible for any damages direct or indirect arising from or related to the used of this information.

All brand names & trademarks are the properties of their respective holders and are referred to here for descriptive purposes only.

Saintink Incorporation (M) Sdn Bhd.
C41, Jln 2A, Kawasan Perindustrian Sg. Lalang 08000 Sg.Petani, Kedah, Malaysia.

Refilling Instruction

>> READ THIS BEFORE REFILLING

Technical details on your **HP Cartridge**

- The cartridge is embedded with a print head. The print head is a delicate component and should be handled with a proper care. Avoid touching the print head.
- Fine electronics at the print head allow the ink to be pumped out in small volume. These electronics are sensitive and are connected to the printer via a thin PC film at the side.
- To continue printing without ink will damage the print head as this electronic will get heated up. Once damaged, the cartridge cannot be used.



saintink.com

HP >> 703, 704 BLACK

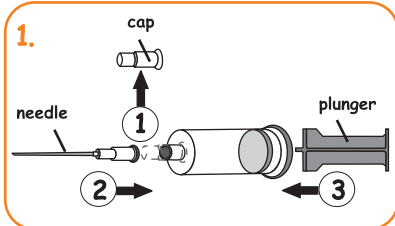

1. Remove the cap then attach the needle to the ink tube. Fix the plunger (per diagram) to allow ease of pressing.

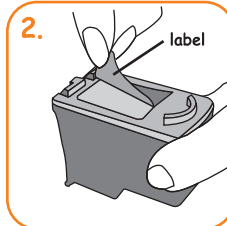

2. Remove the label on the cartridge.

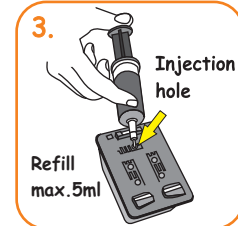

3. Push the needle straight into the cartridge and pull out a little (2mm). Slowly press the plunger to inject about 5ml of ink into the cartridge. Ensure cartridge is in upright position. Stop filling if ink start to drip at print head.

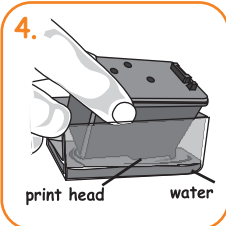

4. Dip the print head of the cartridge into water for 10 seconds.

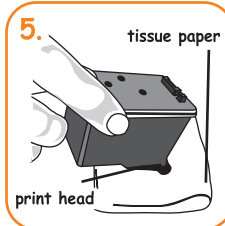

5. Gently stamp the print head on tissue paper.

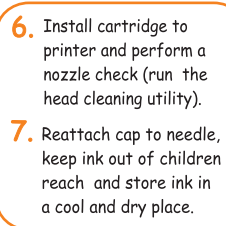

6. Install cartridge to printer and perform a nozzle check (run the head cleaning utility).
7. Reattach cap to needle, keep ink out of children reach and store ink in a cool and dry place.

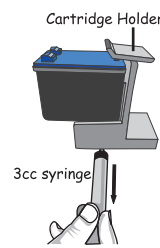

CARTRIDGE HOLDER AVAILABLE.

To be bought separately.

Note : In improving the print quality, this holder is used for **cleaning the cartridge nozzle.**

HP >> 703, 704 C,M,Y

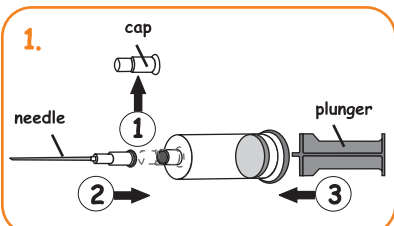

1. Remove the cap then attach the needle to the ink tube. Fix the plunger (per diagram) to allow ease of pressing.

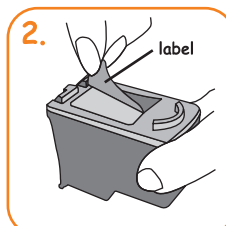

2. Remove the label on the cartridge.

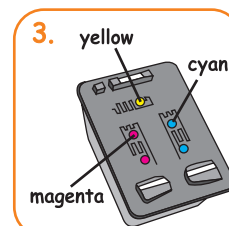

3. Study the position of the color and ensure the right color ink is injected into cartridge.



4. Push the needle straight into the cartridge and pull out a little (2mm). Slowly press the plunger to inject about 3ml per color of ink into the cartridge. Ensure cartridge is in upright position.

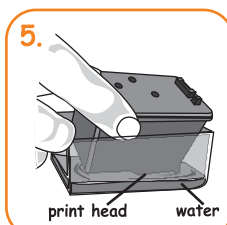

5. Dip the print head of the cartridge into water for 10 seconds.

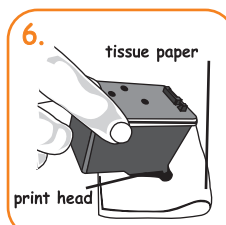

6. Gently stamp the print head on tissue paper.

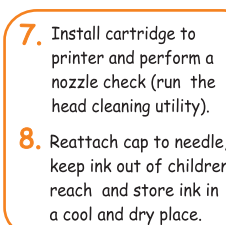

7. Install cartridge to printer and perform a nozzle check (run the head cleaning utility).
8. Reattach cap to needle, keep ink out of children reach and store ink in a cool and dry place.