

INSTRUCTION MANUAL FOR MR. DAMPER INSTALLATION

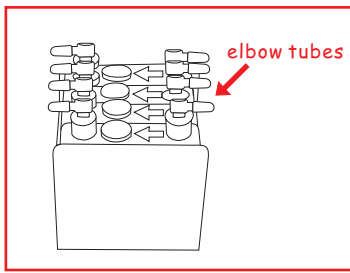

1. Turn all the 8 ELBOW TUBES, so that it faces outside as shown in the pictures.

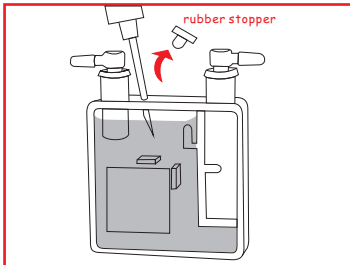

2. Pull out the RUBBER STOPPER on the DAMPER. Push the needle into the DAMPER and slowly fill up the DAMPER with ink until its 95% full. Then, re-insert the RUBBER STOPPER. Follow this step in filling up each ink color (BCMY) into each DAMPER.

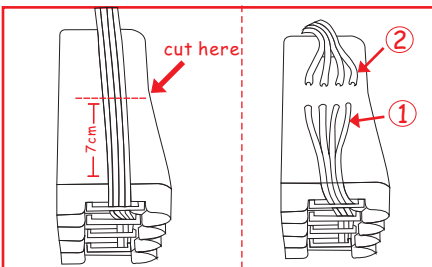

3. Use a scissor to cut the PIPELINE about 7cm from the end of one side of CISS tank. The PIPELINE will become into 2 parts.

Remark : Lay down the CISS tank on a flat surface to prevent the ink from the CISS tank to flow out during installation processes.

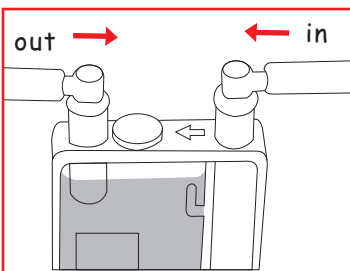

4. Attach the end of PIPELINE No. (1) to the 'IN' ELBOW TUBE properly for each color.

Remark : Make sure the correct color of PIPELINE is attached to the correct DAMPER.

Then, attach the end of PIPELINE No. (2) to the 'OUT' ELBOW TUBE for each color.

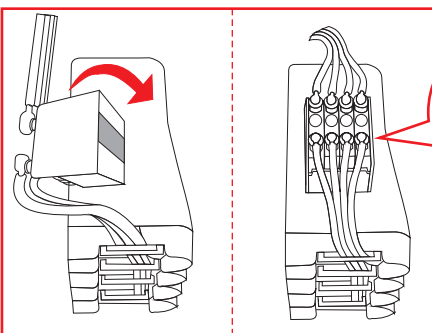

Color:
Y, C, B, M

5. Attach the DAMPER HOLDER to the CISS tank using the double sided foam tape given. Then, arrange the DAMPER into the HOLDER accordingly as shown.

6. Connect the other end of PIPELINE to the cartridge as usual.

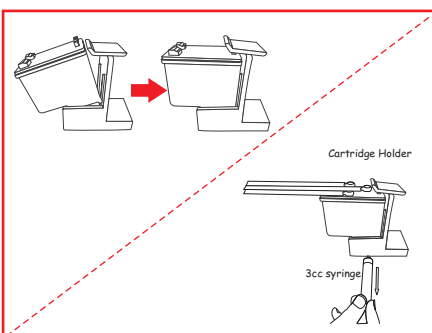

7. Insert the cartridge into the HOLDER and push the top of the cartridge all the way until you hear it "clicking". Connect the 3cc syringe to the rubber holder of the HOLDER and slowly suck out 0.5ml of ink from the cartridge. Remove the cartridge from the holder and clean the excessive ink around the nozzle, dabbing the nozzle pat on soft tissue. Then, install the cartridge into the printer. Properly fix up the CISS tank to the printer.

8. Run the HEAD CLEANING processes before use.

* Please visit the youtube address for more detail video instruction
(<http://www.youtube.com/watch?v=csX-Bo35c1c>)